

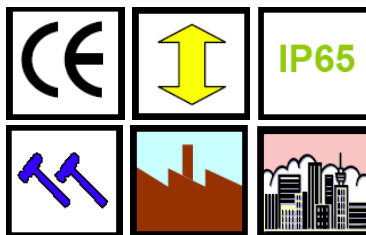

Manufacturers of Commercial, Industrial & Special Purpose Light Fittings



Attributes

- **Strong IP65 Polycarbonate construction**
- **Integral Long Life Batteries**
- **Easy Installation**
- **Aesthetically Pleasing Profile**
- **Good Photometric Performance**

Description

A range of integral IP65 emergency fittings for wall or ceiling mounting internally or externally. The luminaire uses a 8W T5 fluorescent lamp in single or twin versions. The body and the diffuser are made from polycarbonate. The range is available with several options including white, chrome or brass semi-recessing trims. The units are designed to provide required illuminance levels on escape routes of most industrial and commercial buildings.

Specification

LAMP TYPE	CATALOGUE NUMBER	WEIGHT (KG)
1 x 8W T5 Fluo (NM - 3hr)	WET 108.NM3	1.7
1 x 8W T5 Fluo (M - 3hr)	WET 108.M3	1.9
2 x 8W T5 Fluo (NM - 3hr)	WET 208.NM3	2.2
1 x 8W T5 Fluo (Slave)	WET 108.S#	1
1 x 8W T5 Fluo (Combined - 3hr)	WET 108.C3	1.9
OPTIONS		
Brass Finish semi-recessing trim	.SRBR	
Chrome finish semi-recessing trim	.SRCR	
White Finish semi-recessing trim	.SRWH	
Slave operating voltage eg. 12/24/50/110/230V ACorDC	.#	
Self test facility on non-maintained version only	.ST	
Push to test switch	.TS	
HF electronic mains ballast	.HF	

Technical

This range is suitable for normal operation from a 230V 50Hz supply. Do not carry out high voltage circuit tests with these luminaires. For any advice regarding the technical aspects of these products please consult our technical department. Installation should always be carried out by qualified and competent persons. Test regularly at recommended intervals to ensure long battery life.

Dimensions

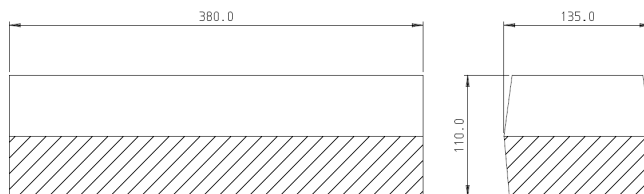

Photometrics

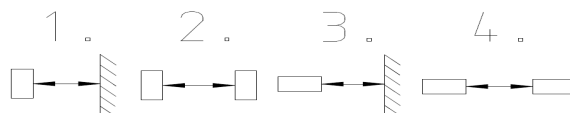

SPACING TABLE

		Mounting Height (m)		
		2.5	4.0	6.0
1. Transverse Distance to Wall For Lux Level	0.2	4.2	4.5	4.0
	0.5	2.8	2.5	n/a
	1.0	2.0	n/a	n/a
2. Transverse to Transverse spacing For Lux Level	0.2	10.8	12.1	12.6
	0.5	7.7	8.0	6.1
	1.0	5.7	4.8	n/a
3. Axial Distance to Wall For Lux Level	0.2	3.8	4.0	3.5
	0.5	2.6	2.2	n/a
	1.0	1.8	n/a	n/a
4. Axial to Axial spacing For Lux Level	0.2	9.4	10.7	11.3
	0.5	6.9	7.1	5.2
	1.0	5.1	4.3	n/a

NB. These are maximum values measured along the centre line of an escape route, and are not to be exceeded. The required minimum level of 0.2 lux is for unobstructed escape route. If there is a possibility of obstructions occurring then a minimum of 1 lux is required. The minimum level for undefined open areas is 0.5 lux, excluding a 0.5m border around the edge of the room which can be at a lower level. These requirements are taken from BS5266/EN1838.